

# COMPONENTS

## ILLUSTRATION

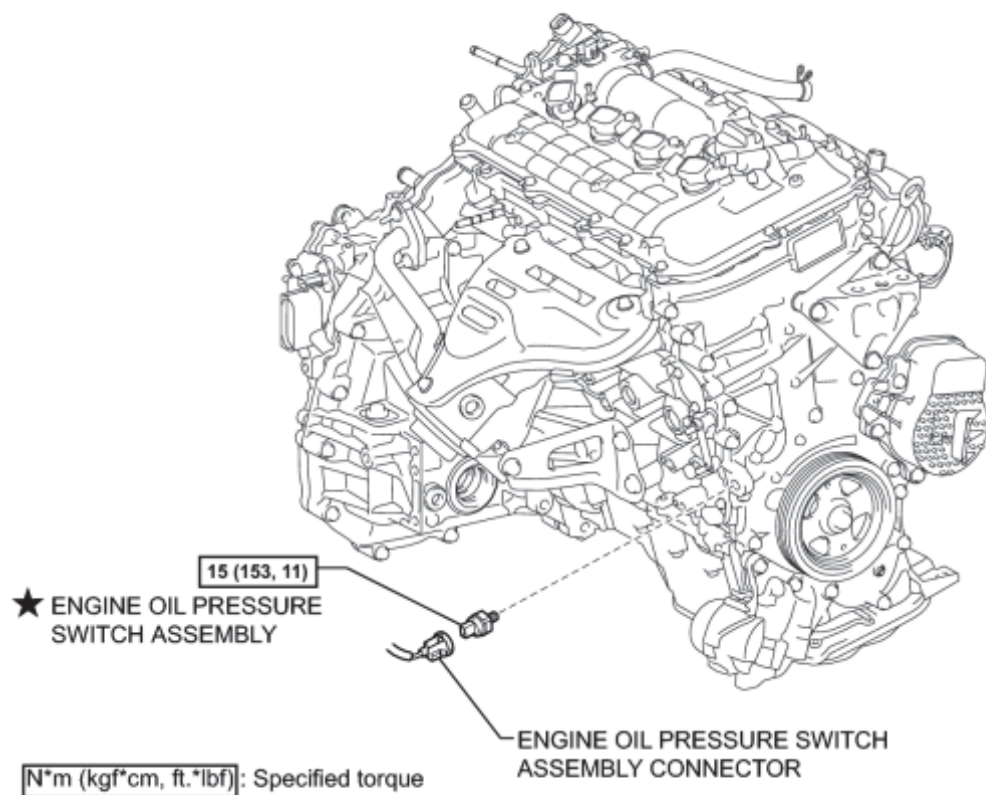

★ Precoated part

c

# REMOVAL

## 1. REMOVE FRONT WHEEL RH

## 2. REMOVE ENGINE OIL PRESSURE SWITCH ASSEMBLY

(a) Disconnect the oil pressure switch connector.

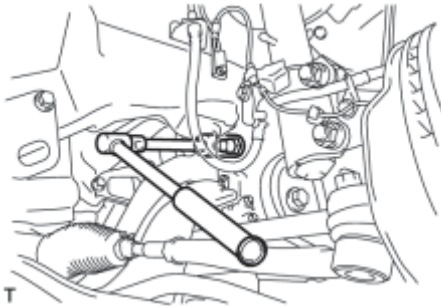

(b) Using a 24 mm deep socket wrench, remove the oil pressure switch.

# INSPECTION

## 1. INSPECT ENGINE OIL PRESSURE SWITCH ASSEMBLY

- (a) Disconnect the oil pressure switch connector.
- (b) Start the engine.

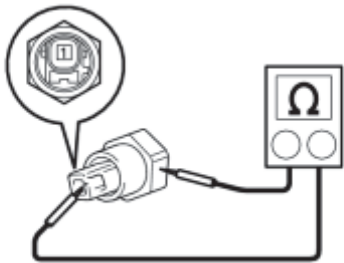

- (c) Measure the resistance according to the value(s) in the table below.

Standard Resistance:

| Tester Connection | Condition      | Specified Condition |
|-------------------|----------------|---------------------|
| 1 - Switch body   | Idling         | 10 kΩ or higher     |
| 1 - Switch body   | Engine stopped | Below 1 Ω           |

If the result is not as specified, replace the oil pressure switch assembly.

- (d) Reconnect the oil pressure switch connector.

# INSTALLATION

## 1. INSTALL ENGINE OIL PRESSURE SWITCH ASSEMBLY

(a) Apply adhesive to 2 or 3 threads of the oil pressure switch.

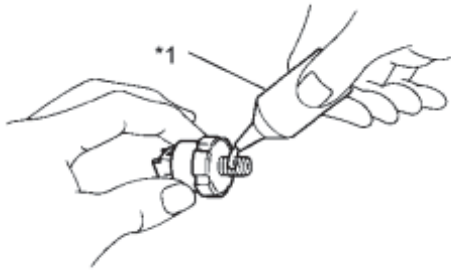

### Text in Illustration

|    |          |
|----|----------|
| *1 | Adhesive |
|----|----------|

Adhesive:

Toyota Genuine Adhesive 1344, Three Bond 1344 or equivalent

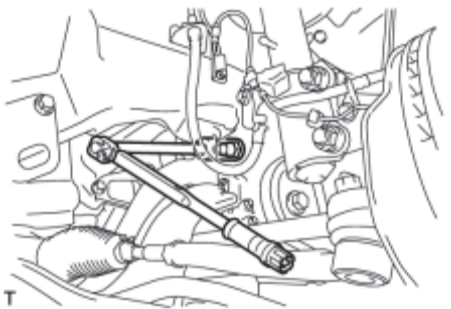

(b) Using a 24 mm deep socket wrench, install the oil pressure switch.

Torque: **15 N·m (153 kgf·cm, 11ft·lbf)**

NOTICE:

Do not start the engine for at least 1 hour after installation.

(c) Connect the oil pressure switch connector.

## 2. INSPECT FOR ENGINE OIL LEAK\_

INFO

## 3. INSTALL FRONT WHEEL RH

Torque: **103 N·m (1050 kgf·cm, 76ft·lbf)**